

TFI..

No.	A	D	L	L1	SW	VPE
TFI1/810	1/8" BSP	10	33	8	14	25
TFI1/410	1/4" BSP	10	33	8	17	25
TFIM1410	M14x1,5	10	32	10	17	10
TFI1/413	1/4" BSP	13	39	8	17	25
TFIM1613	M16x1,5	13	40	10,5	22	10
TFI3/813	3/8" BSP	13	40	8	19	25

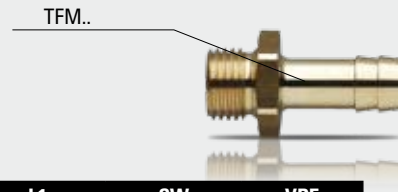
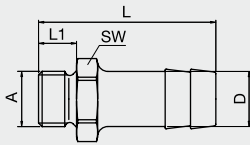

TFM..

No.	A	D	L	L1	SW	VPE
TFM810	M8x0,75	10	33,5	7	11	25
TFM1010	M10x1	10	33,5	7	11	25
TF1/810	1/8" BSP	10	33	7	14	25
TF1/410	1/4" BSP	10	35	9	17	25
TFM1213	M12x1,5	13	40	9	15	25
TF1/413	1/4" BSP	13	42	9	17	25
TFM1413	M14x1,5	13	43	10	17	10
TFM1613	M16x1,5	13	40	9	17	10
TF3/813	3/8" BSP	13	42	9	19	25
TFM2419	M24x1,5	19	56	16	27	10
TF1/219	1/2" BSP	19	54	12	24	10
TF3/419	3/4" BSP	19	60	16	32	10

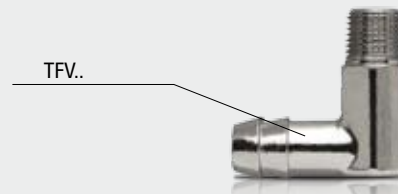
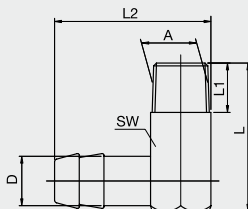

TFV..

No.	A	D	L	L1	L2	SW	VPE
TFVM810	M8x0,75	10	27	9	33,5	11	25
TFVM1010	M10x1	10	27	9	28,5	11	25
TFV1/810*	1/8" BSP	10	27	9	28,5	11	25
TFV1/410*	1/4" BSP	10	34	11	40	15	25
TFV1/413*	1/4" BSP	13	34	11	40	15	25
TFVM1413	M14x1,5	13	34	11	40	15	10
TFV3/813*	3/8" BSP	13	35	12	42	17	25
TFVM2419	M24x1,5	19	47	16	58,5	24	10
TFV1/219*	1/2" BSP	19	47	16	58,5	24	10

* Nickel plated / vernickelt / nickelé

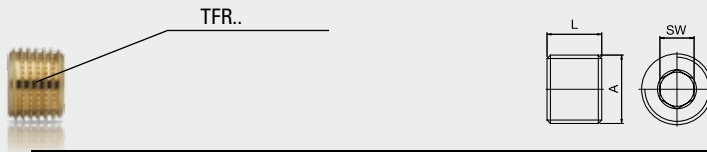

TFR..
conical

No.	A	L	SW	VPE
TFRM8	M8x0,75	8	4	100
TFRM10	M10x1	8	5	100
TFR1/8*	1/8" BSPT	8	5	100
TFRM12	M12x1,5	8	6	100
TFR1/4*	1/4" BSPT	10	7	100
TFRM14	M14x1,5	10	7	100
TFR3/8*	3/8" BSPT	10	8	100
TFR1/2*	1/2" BSPT	10	10	100

* Nickel plated / vernickelt / nickelé

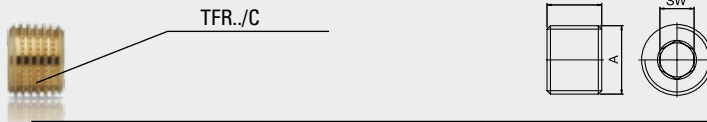

TFR../C
cylindrical

No.	A	L	SW	VPE
TFRM8C	M8x0,75	8	4	100
TFRM10C	M10x1	8	5	100
TFR1/8C*	1/8" BSP	8	5	100
TFRM12C	M12x1,5	8	6	100
TFR1/4C*	1/4" BSP	10	7	100
TFRM14C	M14x1,5	10	7	100
TFR3/8C*	3/8" BSP	10	8	100
TFR1/2C*	1/2" BSP	10	10	100

* Nickel plated / vernickelt / nickelé

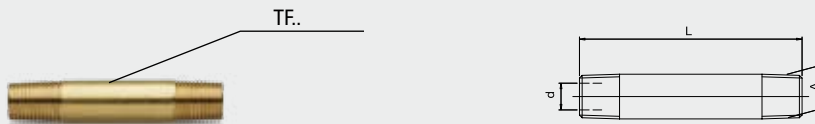

TF..

No.	T	L	d	VPE
TF1/8/50	1/8" BSPT	50	6	10
TF1/8/100	1/8" BSPT	100	6	10
TF1/8/150	1/8" BSPT	150	6	10
TF1/8/200	1/8" BSPT	200	6	10
TF1/4/50	1/4" BSPT	50	9	10
TF1/4/100	1/4" BSPT	100	9	10
TF1/4/150	1/4" BSPT	150	9	10
TF1/4/200	1/4" BSPT	200	9	10
TF3/8/100	3/8" BSPT	100	12	10
TF3/8/150	3/8" BSPT	150	12	10
TF3/8/200	3/8" BSPT	200	12	10

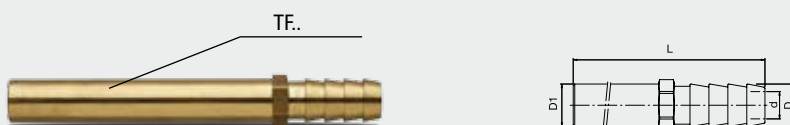

TF..

No.	D	D1	d	L	SW	VPE
TF10/120	10	10	6	120	11	10
TF10/240	10	10	8	240	11	10
TF13/150	13	14	9	150	15	10
TF13/300	13	14	9	300	15	10

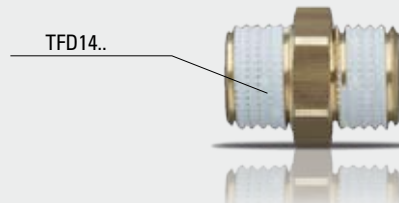
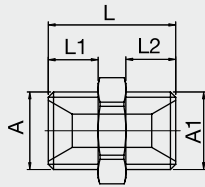

TFD..

No.	A	A1	L	L1	L2	SW	VPE
TFD14	M14x1,5	M14x1,5	23	9	9	17	10
TFD14-1/4	M14x1,5	G 1/4	23	9	9	17	10
TFD1/4	G 1/4	G 1/4	23	9	9	17	10
TFD16	M16x1,5	M16x1,5	23	9	9	19	10
TFD16-3/8	M16x1,5	G 3/8	23	9	9	19	10
TFD3/8	G 3/8	G 3/8	23	9	9	19	10
TFD1/2-14	G 1/2	M14x1,5	27	12	9	22	10
TFD1/2-16	G 1/2	M16x1,5	27	12	9	22	10
TFD1/2	G 1/2	G 1/2	30	12	12	22	10
TFD24-1/2	M24x1,5	G 1/2	36	16	12	27	10
TFD3/4	G 3/4	G 3/4	40	16	16	27	10
TFD3/4-24	G 3/4	M24x1,5	40	16	16	27	10

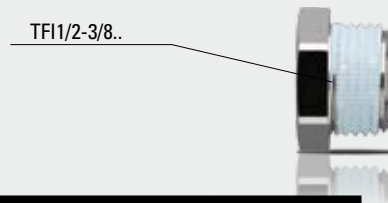
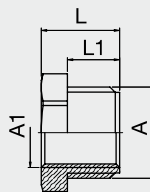

TF..

No.	A	A1	L	L1	SW	VPE
TF1/4-1/8	G 1/4	G 1/8	11	7	17	10
TF14-10	M14x1,5	M10x1	11	7	17	10
TF3/8-1/4	G 3/8	G 1/4	13	9	19	10
TF18-14	M18x1,5	M14x1,5	14	9	22	10
TF1/2-3/8	G 1/2	G 3/8	18	12	24	10
TF3/7-1/2	G 3/4	G 1/2	24	16	27	10
TF24-16	M24x1,5	M16x1,5	24	16	27	10

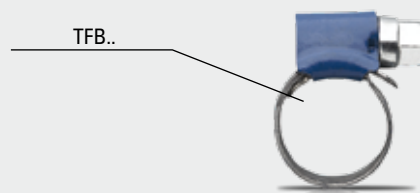

TFB..

No.	D	d	VPE
TFB0814	8-12	8	50
TFB1016	10-17	10	50
TFB1318	12-22	13	50
TFB2232	22-32	19	50

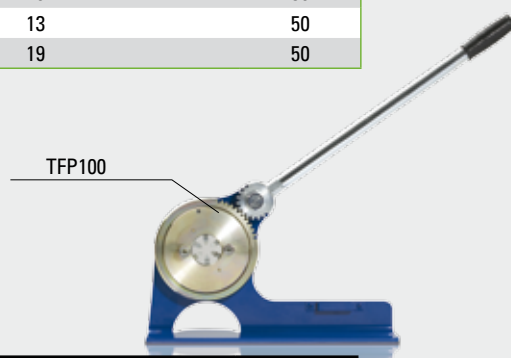

TFP..

No.	D	VPE
TFP100	10-36	1

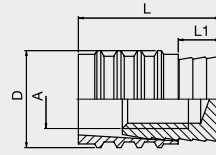

TFVS..

No.	A	D	L	L1	VPE
TFVS6	M3	6	11,5	3,5	100
TFVS8	M4	8	11,5	3,5	100
TFVS10	M6	10	14	4	100
TFVS12	M6	12	14	4	100
TFVS16	M8	16	16	4	100

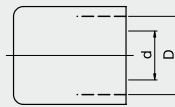
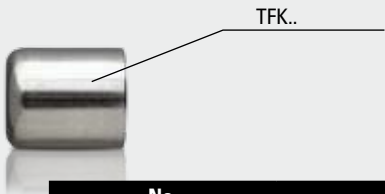

TFK..

No.	D	d	VPE
TFK1510	15	10	100
TFK1610	16	10	100
TFK1810	18	10	100
TFK1913	19	13	100
TFK2013	20	13	100
TFK2313	23	13	100
TFK2919	29	19	50

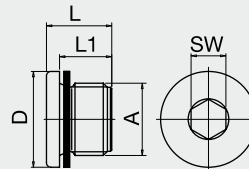
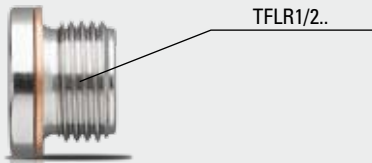

TFL..

No.	A	D	L	L1	SW	VPE
TFLM10	M10x1	14	11	8	5	25
TFLR1/8	G 1/8	14	11	8	5	25
TFLM12	M12x1,5	17	15	12	6	25
TFLR1/4	G 1/4	18	15	12	6	25
TFLM14	M14x1,5	19	15	12	6	25
TFLR3/8	G 3/8	22	15	12	8	25
TFLR1/2	G 1/2	26	18	14	10	25

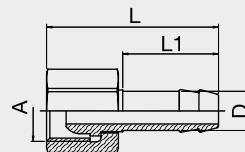
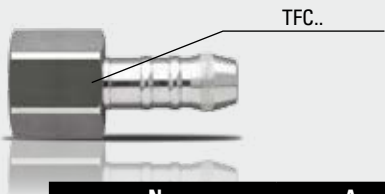

TFC..

No.	A	D	L	L1	SW	VPE
TFC14	M14x1,5	9	39,5	22	17	10
TFC1/4	G 1/4	9	39,5	22	17	10
TFC16	M16x1,5	13	39	25	22	10
TFC3/8	G 3/8	13	39	25	22	10
TFC1/2	G 1/2	13	45	25	24	10
TFC24	M24x1,5	19	52	32	30	10
TFC3/4	G 3/4	19	52	32	32	10